

Becklin Homestead County Park / WMA 34605 Holly St NW, Cambridge MN 55008

The park is located in Springvale township 3.5 miles north west of Cambridge. From Co. Rd 14 go west on 339th Ave NE to 341st Ave, road turns north into Holly St NW, the park is on the right hand side.

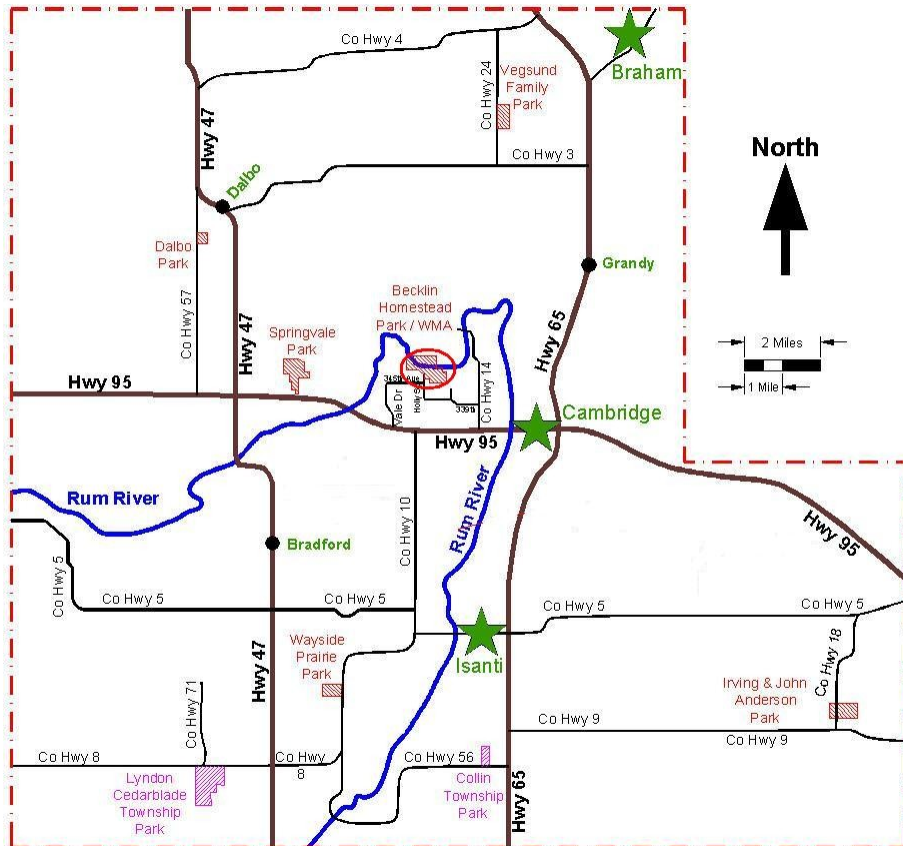

Isanti County Parks Department
555 18th Ave SW
Cambridge MN 55008
(763) 689-8220

VISION | SHIP
A Better State of Health | Statewide Health Improvement Program

<http://www.co.isanti.mn.us/parksrehome.htm>

BECKLIN HOMESTEAD COUNTY PARK / WMA

Becklin Homestead County Park / WMA was purchased in 2004 from the Becklin Family who homesteaded the property since 1898. The Isanti County Parks Department along with the state Department of Natural Resources cooperatively own and manage this property to provide high quality wildlife habitat and to provide outdoor nature based recreational opportunities.



Some activities at the park include a self guided interpretive trail through old growth white pines, geocaching, multi use trails, wildlife observation blinds, and access to the Wild & Scenic Rum River.

There are currently seven wildlife blinds located throughout the park. These blinds are for wildlife observation and are also available to disabled hunters to pursue wild turkeys and white tailed deer along with waterfowl hunting through the Capable Partners Program. To find out more about Capable Partners visit their website at <http://www.capablepartners.org/>

BECKLIN HOMESTEAD COUNTY PARK / WMA

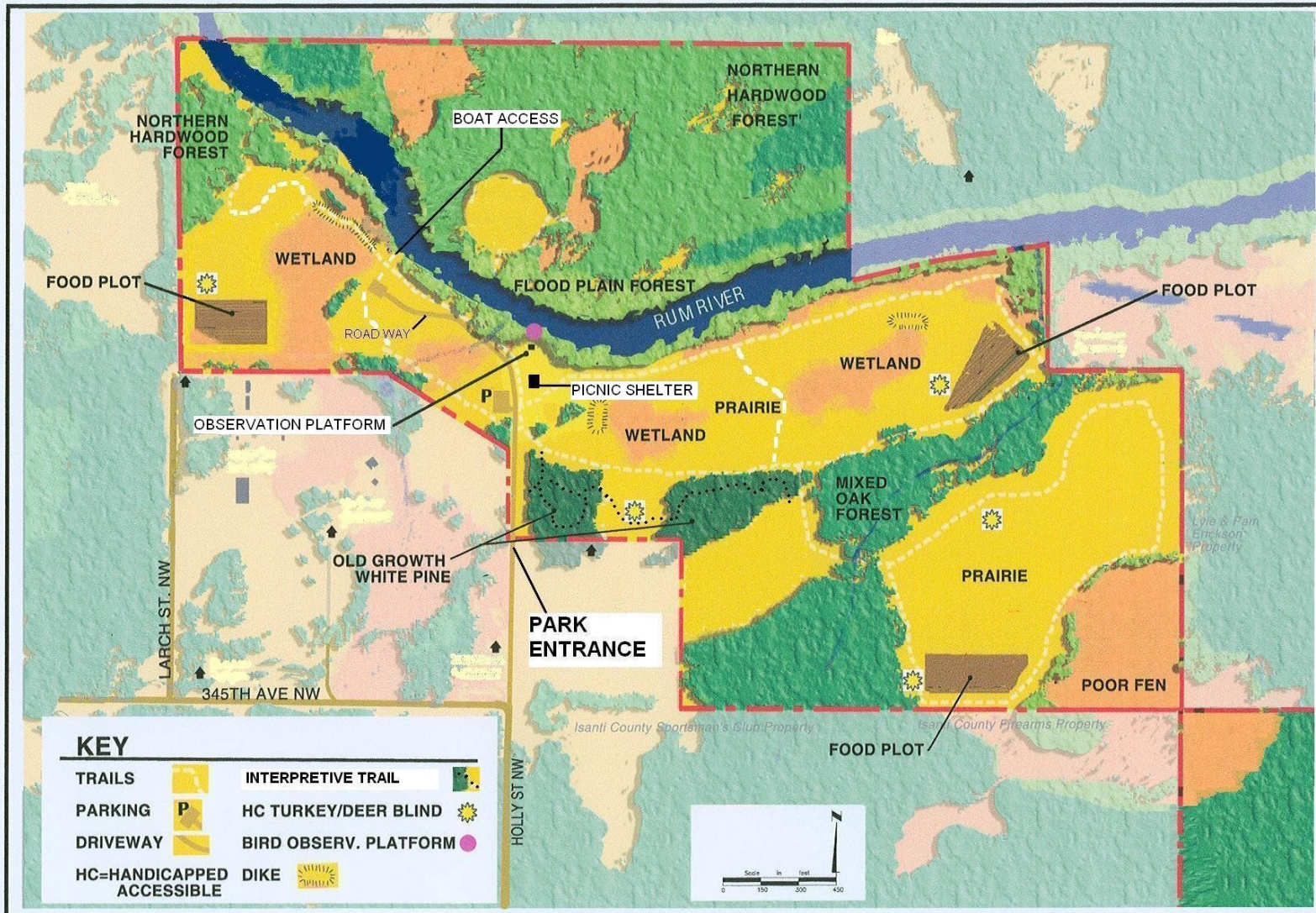

FACILITIES

Facilities currently include a parking area, Information Kiosk, picnic tables, benches, picnic shelter, restroom, and river access.

TRAIL SYSTEM

There are 2.5 miles of multi use trails open to: hiking, biking, running, cross country skiing, and snowshoeing.

Horseback riding is not permitted in this park.

THINGS TO REMEMBER

Please keep pets on a leash and pick up after them while enjoying the park.

Go to parks website for Rules & Regulations and to view park ordinance.

